

## « Xtension Pro™ » Transport Mounting Support For use with cot / stretcher for patient

### Characteristics

- Lightweight materials
- Anodized
- Constant clamping mechanism for medical devices
- Compact format
- Safe for crew
- Compatible with Technimount stretcher frame

### Applications

- Patient stretcher
- Crash Carts
- Working Surfaces
- Hospital bed
- Biomedical workshop

### Product benefits

- Both sides installation
- No modifications needed for stretcher or medical device
- Adapted for narrow space in ambulance
- Fully warranty for 1 year
- Resistant to biological fluids and sodium
- Electrochemical coated for increased durability

Any medical equipment that has been inadequately installed in ambulances, helicopters and other emergency medical service vehicles (EMS) and crash carts, can potentially pose a serious risk or become dangerous in the event that the vehicle makes frequent or sudden stops, turns or rushed departures. This situation can result in damaged expensive medical equipment or even inflict injuries on a patient, ambulance personnel or clinic staff.



The **Xtension Pro™** mounting system offers to offer the quickest solution for transporting medical equipment using a stretcher. The **Xtension Pro™** allows you to temporarily transform your stretcher by quickly adding an additional mounting plate or extra working surface that is both safe and easy to use. The **Xtension Pro™** medical mounting plate is both compact and lightweight and features a standardized system, designed to fit every new ambulance vehicle configuration, making it perfectly adaptable on either side of any medical stretcher frame (Technimount

Product No. 510-10-XXX). It comes complete with locking clamp mechanism to secure the system on side rails or devices equipped with the Technimount adapter. Armed with two convenient clamping mechanisms, the medical mounting plate is a true time saver when it comes to positioning medical devices in relation to a patient, and to ensure the patient's safety during evacuation and transport in a vehicle or compartment. The **Xtension Pro™** can transform your stretcher without compromising its functionality. It features an impact-resistant design that can withstand several times the force of gravity. In order to avoid costly repairs, replacements of damaged equipment as well as potential lawsuits in the event of injury, consider fitting your stretcher with a mounting system for medical devices.

**Technimount System Inc.** manufactures, sells, distributes and markets restraint and support systems for all brands of emergency vehicle defibrillators and can be adapted for hospitals, emergency services or military applications.

For use with the [Technimount « Stretcher Safety Arm System™ »](#) support systems.

## TECHNICAL SPECIFICATIONS

<b>Product Name:</b>	<b>Xtension Pro</b>
<b>Compatible model:</b>	“Safety Arm System” Mounting bracket support series
<b>Application environment:</b>	SPU/SAMU - Hospitals - Biomedical Workshops - Clinics
<b>Manufacturing Equipment:</b>	Base: Hard-anodized High Density Aluminum process Extension Support: Stainless steel 316 - Sustarin (Delrin)
<b>Operating temperature:</b>	- 35° C to 45° C (Direct Conduction)
<b>Impact Resistance<sup>1</sup>:</b>	<b>(1.5 M drop test)</b> for stand alone product; and/or Identical to <i>Stretcher Safety Arm System</i> with clamp box
<b>Nbr of Mounting points:</b>	2 points on stretcher side rails- disc locking mechanism
<b>Dimensions</b> Approx. Overall:	16-1/2” L x 11-3/8” D x 8-3/4” H Top. (pc.) Plate Height: 2”
<b>Installation:</b>	Can be installed on either <i>left or right side</i> of the stretcher with suitable frame (510-10-XXXX) or <b>(510-10-XXXX-LFS)</b>
<b>Weight:</b>	Total: 9.14 lbs. (Plate only - without device)
<b>Advantages:</b>	Compatible with Technimount stretcher support frame Quick, safe and consistent locking system Vertical or horizontal locking mechanism for stretchers Moving parts in red for quick identification Adaptable plate for narrow vehicle configuration No modification of medical devices needed
<b>Product No <sup>2</sup>:</b>	590-00-LFS-MQ - <b>Complete</b> Xtension Pro for <b>Maquet Mechanical Heart</b> (Cardiohelp) 590-14-LFS-UN - Xtension Pro for <b>Inside Stretcher Frame</b> , Left Side, Universal 590-15-LFS-UN - <b>Complete</b> Xtension Pro For Inside and Outside Stretcher <b>Frame</b> 590-16-LFS-UN - Xtension Pro For <b>Outside Stretcher Frame</b> , <b>Elongated</b> Left Side 590-20-LFS-MQ - Xtension Pro, <b>Lateral Plate Support Only</b>

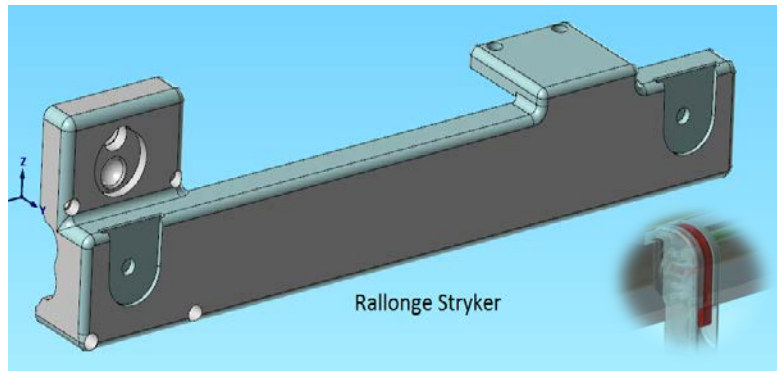

Recommended Installations (Stryker Extension)

<sup>1</sup> Technimount System Inc. aim to offer products that meet and exceed the required industry norms for support systems in emergency vehicles or hospital settings, in accordance with Provincial and Federal government laws. In the event of a possible divergence from the applicable laws in your area, contact your administrator.

<sup>2</sup> The article number must be confirmed before sending the order form. Technimount System Inc. Reserves the right to make changes to the product or its documentation without notice. DOCUMENTS PRINTED IN CANADA  
CGC Technologies - Medical Equipment & Accessories Division - Registered Trademark 2013